



EVENT GUIDE

SPORTS & SOCIAL[®]

Steel City

Live! Casino Pittsburgh[®]
5260 Route 30, Greensburg, PA 15601

The Experience

Sports & Social® is a one-of-a-kind sports bar, gaming parlor and social lounge in Live! Casino Pittsburgh®. It's the ultimate clubhouse during home and away games, featuring a 40' high-definition LED TV and showcasing the top sports-watching events year-round. Equipped with a FanDuel Fan Cave, shuffleboard, foosball, air hockey, Skee-ball®, pop-a-shot basketball, cruise ship shuffleboard, golf simulator, bowling and more!

It's sure to please everyone in your group, combining the traditional elements of a sports tavern with classic interactive games and expansive seating. Sports & Social® is the perfect destination for groups, professionals and all those whose competitive spirit thrives.



All Day Hits

\$45 PER PERSON. SERVED AT THE TABLE. 12 PERSON MINIMUM

To Share Choose 3. Served family-style

CACIO E PEPE ARANCINI

Parmesan, truffle aioli,
crispy parsley

LOADED NACHOS

blended cheese, black beans,
pico de gallo, fresh jalapeños,
sour cream, guacamole

SOUTHWEST CHICKEN FLATBREAD

shredded cheese blend, roasted
peppers, jalapeños, pico de gallo,
avocado crema

BONELESS WINGS

crispy fresh (never frozen)
hand-cut chicken breast;
choice of Buffalo, bbq, zesty garlic or bee
sting flavor; served with ranch
or blue cheese

SPINACH ARTICHOKE DIP

grilled flatbread, tortilla chips

SIGNATURE SWEET BAY FRIES

crinkle cut fries, sweet bay seasoning,
cheese sauce

Main Event Choose 3. (Choice of 1 per guest selected on the day of the event)

CAESAR SALAD

romaine, garlic croutons, shaved
Parmesan, classic Caesar dressing
chicken breast +6pp
sautéed shrimp +8pp

SOUTHWEST BOWL

grilled chicken, black beans, pico de
gallo, avocado, red cabbage slaw, cilantro,
crispy tortilla, Cotija cheese, steamed
rice, chimichurri ranch
substitute sautéed shrimp +3pp

NASHVILLE HOT CHICKEN SANDWICH

buttermilk marinated breast, Nashville-
style spices, coleslaw, house-made
pickles

CLASSIC CHEESEBURGER

lto, house-made pickles, garlic aioli;
choice of American, Cheddar, pepper
jack, Swiss or blue cheese

PHILLY CHEESESTEAK

shaved ribeye, sautéed onions,
hoagie roll, whiz

ITALIAN HOAGIE

mortadella, Genoa salami, pepperoni,
provolone, lettuce, tomato, onion,
cherry hots

Desserts

Served family-style

APPLE COBBLER

cinnamon streusel, brown-sugar ice cream

ASSORTED COOKIES

assortment of bakery classics

Raising the Sports Bar®

Event Menu

SNACKS

Choice of 4 @ \$25 per person. Choice of 6 @ \$35 per person.
Served 60 minutes. Minimum 20 guests.

Passed

PRETZEL BITES

served with beer cheese and spicy mustard

BONELESS WINGS

crispy fresh (never frozen)
hand-cut chicken breast;
choice of Buffalo, bbq, zesty garlic or bee sting flavor; served with ranch or blue cheese

PIEROGIES

potato-stuffed, caramelized onions, sour cream

CLASSIC CHEESEBURGER SLIDERS

lto, house-made pickles, garlic aioli;
choice of American, Cheddar, pepper jack, Swiss or blue cheese

CACIO E PEPE ARANCINI

Parmesan, truffle aioli, crispy parsley

ITALIAN HOAGIE BITES

mortadella, Genoa salami, sopressata, provolone, lettuce, tomato, onion, mayo, cherry hots

CRISPY KATAIFI SHRIMP

bang bang sauce, togarashi, lime

Stationary

SPINACH & ARTICHOKE DIP

grilled flatbread, tortilla chips

SEASONAL VEGETABLE CRUDITÉ

carrots, squash, zucchini, cauliflower, grape tomatoes; served with house-made ranch dip

HOMEMADE POTATO CHIPS

applewood smoked bacon-sour cream dip

LIVE!® NACHOS

hand-cut chips, blended cheese, black beans, pico de gallo, fresh jalapeños, sour cream, guacamole

CHEESE & CHARCUTERIE BOARD

artisanal cheese, marinated vegetables, assorted meats, dried fruit, spiced nuts, olives

SIGNATURE SWEET BAY FRIES

crinkle-cut fries, sweet bay seasoning, cheese sauce

CAESAR SALAD

romaine, garlic croutons, shaved Parmesan, classic Caesar dressing
chicken breast +6pp
sautéed shrimp +8pp



Raising the Sports Bar®

Event Packages

STATIONS

Stations are open for 90 minutes. Minimum 20 guests.

Tacos & Amigos

\$29 per person

CHICKEN BACON-RANCH SOFT CRUNCH TACOS

crispy ancho spiced chicken, applewood smoked bacon, pico de gallo, cheese sauce, house slaw, soft flour and crunchy corn tortillas

BEEF BARBACOA TACOS

caramelized onions, Cotija, pico de gallo, flour tortilla, avocado crema

FRESH TORTILLA CHIPS

salsa roja

ADD-ONS

Tempura Mahi Fish Tacos 12

red cabbage slaw, tomatillo sauce, avocado crema, Cotija cheese, cilantro, flour tortilla

Southwest Chicken Flatbread 10

shredded cheese blend, roasted peppers, jalapeños, pico de gallo, avocado crema

Nacho Chicken Quesadilla 10

pico de gallo, Cheddar, salsa roja, sour cream

VEG OPTION

Southwest Bowl 7

black beans, avocado, pico de gallo, red cabbage slaw, crispy tortilla strips, chimichurri ranch, Cotija, white rice

Keeping it Social

\$30 per person

LIVE!® NACHOS

cheese sauce, black beans, pico de gallo, jalapeños, salsa, guacamole, choice of chicken or beef barbacoa

WINGS

choose traditional, boneless; choice of sauce, standard accompaniments

SIGNATURE SWEET BAY FRIES

crinkle-cut fries, cheese sauce

HOMEMADE POTATO CHIPS

smoked bacon-sour cream dip

ADD-ONS

Cheeseburger Sliders +8pp

Giant Pretzel +6pp

stout beer cheese sauce

Grilled Brats & Hot Dogs +7pp

spicy mustard

Mac and Cheese +6pp

VEG OPTION

Caesar Salad +6pp

romaine, garlic croutons, shaved Parmesan, classic Caesar dressing

The "MVP"

\$50 per person

S&S SIGNATURE STATION

loaded chicken nachos
loaded cheeseburger tots
traditional & boneless wings
chips & dip

SOCIAL SNACKS

homemade potato chips, smoked bacon-sour cream dip

ADD-ONS

Kataifi Shrimp 10

togarashi, lime, bang bang sauce

Mini Philly Cheesesteak 11

shaved ribeye, sautéed onions, whiz, club roll

BBQ Pork Sliders 12

house pickles, coleslaw, toasted bun

VEG OPTION

Korean Bowl 9

marinated chicken, julienned carrots, red cabbage, charred broccoli, cucumber, romaine lettuce, sesame seeds, green onions, steamed rice, gochujang sauce, soy sauce

Raising the Sports Bar®

SWEET ENDINGS

\$11 per person, served up to 60 minutes

DESSERT BARS

fudge brownies, lemon bars, mini cheesecake, layer bars

SEASONAL COBBLER

streusel, vanilla whipped cream

BRIOCHE BREAD PUDDING

dark chocolate, vanilla whipped cream

FRESH BAKED COOKIES

assortment of bakery classics

Beverages

Silver

\$25/person - 2 hours
Additional hours - \$9/person

DOMESTIC BEERS
HOUSE WINES

Gold

\$29/person - 2 hours
Additional hours - \$12/person

DOMESTIC BEERS
CRAFT BEERS
IMPORT BEERS
HOUSE WINES
CALL COCKTAILS

Platinum

\$35/person - 2 hours
Additional hours - \$15/person

DOMESTIC BEERS
CRAFT BEERS
IMPORT BEERS
HOUSE WINES
PREMIUM SPIRITS
SIGNATURE COCKTAILS

DRINK TICKETS \$7.50 Silver | \$9.50 Gold | \$11.50 Platinum | \$3 Non-Alcoholic

* Can order additional drink tickets during event in increments of ten. Unused drink tickets cannot be credited back.

Raising the Sports Bar®

A 24% Event Management Fee and sales tax are applied to all menu selections.
Prices are subject to change on market value.

Floor Plan

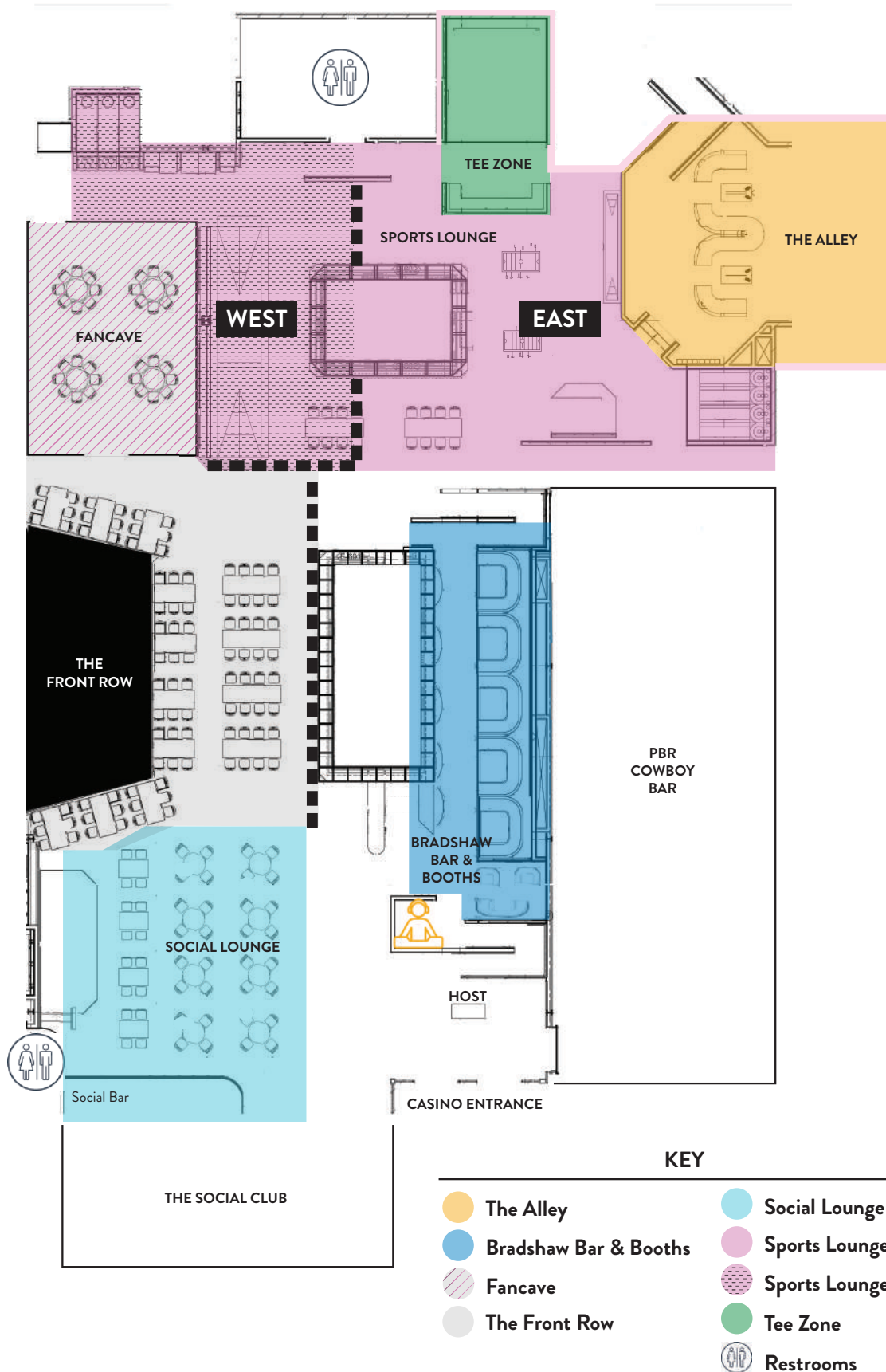

Capacities

LOCATION	GAMING/INCLUSIONS	SEATED / COCKTAIL
THE ALLEY 4 LANES	Bowling	20 / 40
TEE ZONE	Golf / Sports Simulator	8 / 12
SPORTS LOUNGE	Private Bar, Bowling, Shuffleboard, Golf Simulator, Pop-a-Shot, Air Hockey, Foosball, Skee-ball® (Game Cards \$20.00)	80- / 150
SPORTS LOUNGE - WEST		20 / 50
SPORTS LOUNGE - EAST		60 / 100
FRONT ROW	40' HDTV Media Wall View	110 / 160
BRADSHAW BAR	Booths, Lounge, Private Bar	54 / 75
SOCIAL LOUNGE	Private Bar	54 / 100
FANDUEL FAN CAVE	173" Big Screen HDTV	40 / 60
THE SOCIAL CLUB		75 / 150
PBR® PITTSBURGH	Private Space & Bar	124 / 260

Full Venue Buyouts Available

Based on 2 hour event times. Please inquire for pricing.



SPORTS & SOCIAL[®] *Steel City*

Contact Us
events@sportssocialsteelcity.com
878-787-7770 ext 4

Pittsburgh.LiveCasinoHotel.com

Live!
CASINO[®]
PITTSBURGH