



EST. THE 1931
POST OFFICE
AN UNBRIDLED COMMUNITY





ABOUT THE POST OFFICE

The Post Office, constructed in 1931, boasts a terra cotta foundation, Spanish tile roof, arches, pilasters, and highly detailed medallions reflective of the architect’s blending of Italian Renaissance Revival and Beaux Arts styles. Original terrazzo and marble floorings, millwork, letterbox, and light fixtures bring a high level of integrity to the interior space which has been listed on the National Register of Historic Places since 1985. Whatever your evening banquet, daytime reception, or meeting needs may be, this newly renovated event center fits the bill, including built-in banquet bar and high-speed wireless internet.

LOCATION

505 Macon Ave, Canon City 81212

VENUE FEATURES

MAIN LEVEL

- Venue square footage: 4500 sq. ft.
- 150 people capacity
- Newly renovated space
- Built-in banquet bar
- Monthly art exhibits curated by the Fremont Center of the Arts, creating a gallery experience for attendees
- High-speed wireless internet available

BOARDROOM

- Venue square footage 800 sq. ft.
- 10 people capacity
- Newly renovated with executive board table and chairs, TV for presentation and lounge space for private meetings
- High-speed wireless internet available

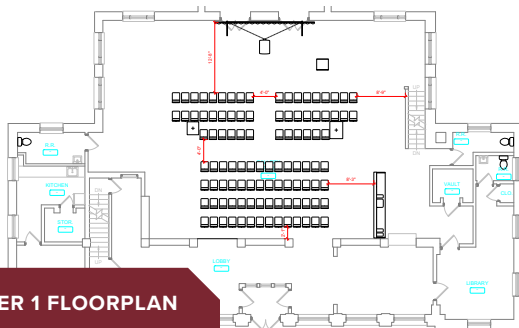

THEATER 1 FLOORPLAN

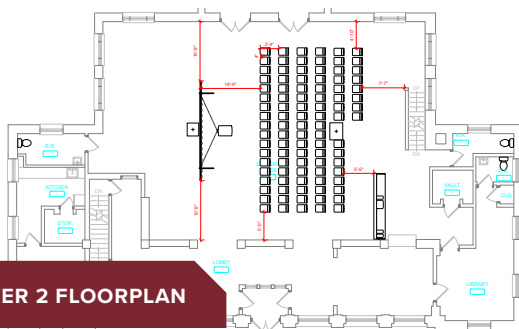

THEATER 2 FLOORPLAN

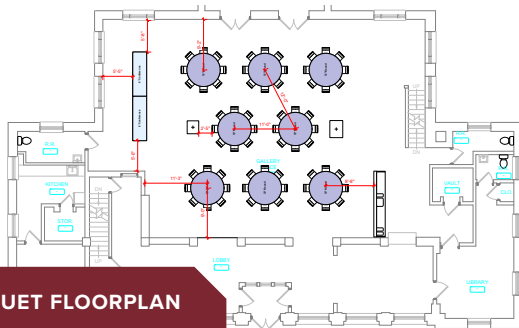

BANQUET FLOORPLAN

CAPACITY

SqFt	Theater 1	Theater 2	Banquet
4500	104	96	64