

Albemarle CIDERWORKS



ALBEMARLE CIDERWORKS
2545 RURAL RIDGE LANE
PO Box 210
NORTH GARDEN, VA 22959
434-297-2326

EVENTS@ALBEMARLECIDERWORKS.COM

WEDDINGS AND WEDDING RECEPTIONS

THE ORCHARD AT RURAL RIDGE

Albemarle CiderWorks is situated on a small farm in central Virginia, some 10 miles southwest of Charlottesville, Virginia. The cidery and its tasting room sit amidst rolling fields and orchards planted with a wide variety of vintage and heirloom fruits, principally apples. Vintage Virginia Apples LLC and Albemarle CiderWorks are a family owned and operated farm enterprise, from which the Shelton family produces distinctive fine ciders. The Albemarle CiderWorks Tasting Room is an elegant and rustic setting for enjoying the ciders and is offered as a venue for special events. The Tasting Room, combined with the adjoining Orchard Room, is ideal for smaller gatherings of up to 80 guests. Larger groups may use tenting options on the grounds.

THE COTTAGE AT RURAL RIDGE

The property also boasts a farmhouse cottage that is available for rentals at www.vrbo.com/469050. Recently remodeled, this circa 1900 farmhouse has four bedrooms, two baths, three generously sized public rooms, a small equipped kitchen, porches and a large yard overlooking the farm pond and orchards.

FEES

MAX 60 PEOPLE
\$4000

INCLUDES TASTING ROOM
AND PATIO

REQUIRES ONE CASE
MINIMUM PURCHASE

MAX 120 PEOPLE
\$8000

INCLUDES TASTING ROOM
AND TENTED PATIO

REQUIRES TWO CASE
MINIMUM PURCHASE

MAX 200 PEOPLE
\$10,000

INCLUDES TASTING ROOM,
PATIO, TENTED LAWN AND
PORTABLE RESTROOMS

REQUIRES TWO CASE
MINIMUM PURCHASE

OTHER CONSIDERATIONS:

A 10% rental discount is applied for events occurring December–March
\$500 Security Deposit; refundable based on terms in event contract
Wedding rehearsal is included in cost

FREQUENTLY ASKED QUESTIONS

1. What is included in your reception package? The flat fee includes access to Cidery property surrounding the tasting room, the tasting room and patio, the catering kitchen and two rest rooms adjacent to the tasting room. The use of the Tasting Room furniture (28" square black metals tables and matching chairs) is also included. Tents are provided based on size of event.

2. **Do I need to make an appointment to meet with someone there or can I just show up?** To ensure that staff is on hand to answer your questions, we require an appointment. Contact us at events@albemarleciderworks.com or 434.297.2326.
3. **What is the typical timing of an event?** The property will be available to you and your vendors within the time frame of your contract and is subject to the tasting room hours. It is recommended that your ceremony commence no earlier than 6 pm to allow for catering set up and arrival of guests after the tasting room closes at 5 pm.
4. **Is catering done on premise or can we hire our own caterer?** ACW maintains an approved list of caterers which range in price and variety of menus. Exceptions must be approved, in advance, by Albemarle CiderWorks.
5. **Do you require a wedding planner?** To ensure smooth communications between ACW and the Lessee, as well as an organized and memorable event, we require the use of an approved event planner. We will have staff on-site during your event responsible for the venue (restrooms, power, etc.). They do not act as event planners/wedding directors.
6. **Are we responsible for set-up/clean-up?** Set-up and clean-up are usually done by the caterer and you should confirm these arrangements with them. Everything must be done the day of the event and within your contracted hours. Trash must be removed from the property at the conclusion of the event. Pick-up of any personal items, flowers, rentals, gifts, etc. stored outside must be completed by 10am the next day.
7. **Do you offer an open bar?** Your bar will be provided through your caterer. Bar selections are permitted with the appropriate ABC license from the caterer. All beverage service is handled through the caterer. No "shots" of liquor or tip jars are permitted during any event. ACW is governed by Virginia ABC liquor laws. No alcohol will be served to guests under the age of 21. Guests should bring proper identification. If there is any doubt of age by the bartender, the guest will be asked for I.D. If no I.D. is provided, alcohol will be withheld.
8. **What, if any, decorations are provided?** None.
9. **What decorating can be done to the space?** Most often we see flowers, candles and lighting. Candle placement (on tables, mantle, under tent, etc.) must be approved prior to the event. No nailing, stapling, taping, or anything to be applied that will cause damage to the walls/poles of the tent, trees, or any buildings is permitted.
10. **What can be used as an exit for the bride and groom?** Any elements used to celebrate the couple's departure should be approved in advance. Any items that are thrown on the ground, must be cleaned up. If sparklers are used, they must be lit outside only (not under the tent) and you must provide receptacles with sand or water for disposal.
11. **Do you include parking and is there a cost for this?** Parking space is included and will be in areas designated by Albemarle CiderWorks. Albemarle CiderWorks will provide signs and a person to direct parking. If desired, you can hire a valet company to assist in parking.
12. **Are you covered by insurance in case of an accident?** The Cidery is insured for its own liability; insurance for the event is also required to be carried by the Lessee. You can obtain this through your homeowners' insurance or www.wedsafe.com.
13. **Can I have additional tents?** Any additional tenting must be arranged through Albemarle CiderWorks. There will be additional costs for additional tents.
14. **What is the cancellation policy?** The deposit is non-refundable and once paid the balance is non-refundable. If we are able to rebook the date, the deposit will be returned.
15. **Will there be another wedding on-site the same day?** No.
16. **Are restrooms available?** There are two unisex bathrooms in the tasting room for events indoors. Portable restrooms are provided for weddings larger than 120.

17. **Do you have any on-premise accommodations?** There is lodging available for up to 8 overnight guests for weekend or weeklong rental. Details of the Farm Cottage are available at www.vrbo.com/469050. Subject to availability.
18. **What is the location of rooms for changing?** There are no dressing or changing rooms available. However, if you have rented Farm Cottage, it can serve as a changing area. Please see above for more information.
19. **Are there rooms for baby-sitting?** If you have rented the Farm Cottage, you may use one of these rooms for babysitting.
20. **Can we post signs to direct wedding traffic to the cidery?** The entrance to ACW is clearly marked and parking signs are provided. Any additional event signs on the property must be approved by ACW staff.
21. **Can we have a rehearsal for our ceremony?** Yes. Timing must be coordinated with the ACW staff. Please make arrangements at least two weeks prior to the day of the event.
21. **Can we take engagement photos on the property?** Yes. Timing must be coordinated with the ACW staff. Please make arrangements at least two weeks prior to the day of the photo shoot.
22. **Are pets permitted for my ceremony?** If you have a pet that you would like to include in your ceremony, please get approval by ACW staff. Guests are not permitted to bring animals unless they require a service dog. All animals must be on a leash and not left unattended.
23. **What hours are available for my event?** Albemarle CiderWorks Tasting Room closes at 5:00 pm. Any vendor access or set up activities prior to this must be coordinated and approved by ACW events staff. No event may start before 6:00 pm.
24. **When do I need to give a headcount?** At least 2 weeks prior to the event. A checklist of items and details of your event will be requested by the Events Staff in order to properly prepare for your day. Per Albemarle County regulations, no event may exceed 200 attendees.
25. **Is there a designated smoking area for my guests?** No smoking will be permitted inside any building or tent. Should lessee request it, an outdoor area for smoking will be designated by Albemarle CiderWorks.
27. **How late are we able to play music at the reception?** Music must end by 11:00 pm per the Albemarle County sound ordinance. We do not allow amplified bands; only DJ's and/or acoustic groups.
28. **Are we allowed to use buses?** Certainly, we encourage you to use buses.

ACW STAFF

434.297.2326

events@albemarleciderworks.com

Kathy Woodson

Charlotte Shelton

physical address:

2545 Rural Ridge Lane

North Garden, VA 22959

mailing address:

Post Office Box 210

North Garden, VA 22959

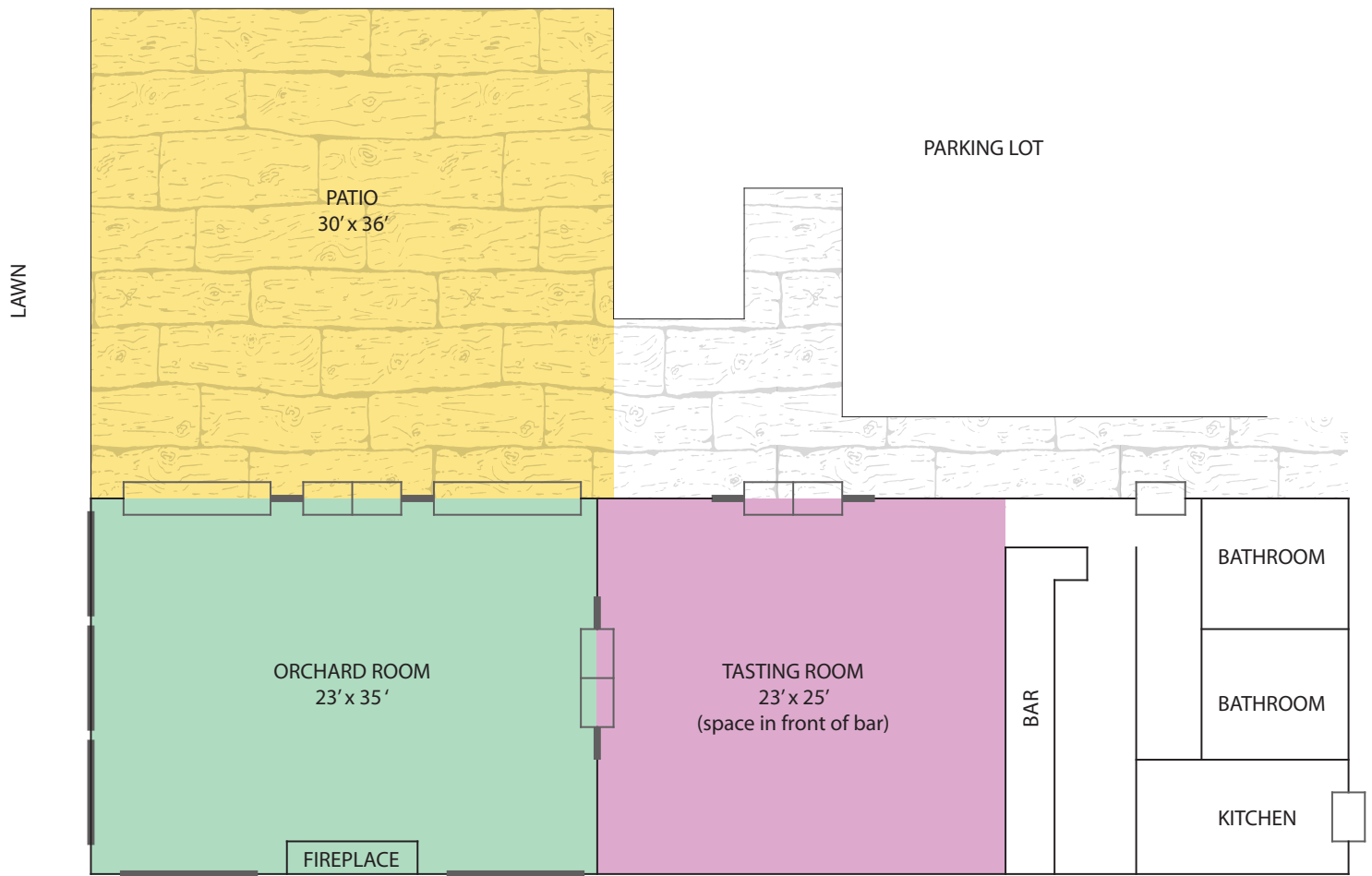

ALBEMARLE CIDERWORKS TASTING ROOM
WWW.ALBEMARLECIDERWORKS.COM



Albemarle CiderWorks Tasting Room & Patio



The Orchard Room