

2020 Guide to the Blowing Rock Conference Center



Your Place in the Mountains

Tel: 828-295-7813

Email: info@brccenter.org

www.brccenter.org

The Blowing Rock Conference Center is located in the beautiful mountain village of Blowing Rock, North Carolina, sitting at the highest point in the village at an elevation of 3800 feet.

Our mission statement: The holy ground of Blowing Rock Conference Center exists so that God's people can gather for community development, education, and spiritual growth.

BRCC offers churches, schools, other non-profit organizations, and even businesses a perfect spot for year round retreats, camps, and conferences.

Our location, just off the Blue Ridge Parkway, can be your jumping-off point for year-round activities, from antiquing and bird watching to golfing and fishing and – for more adventurous souls – hiking, whitewater rafting, tubing, snow skiing, mountain biking, and climbing.

Blowing Rock Conference Center is within a two-hour drive from the Charlotte, NC or Greensboro, NC airports. The Hickory Hop provides transportation.

Come and be our guest!

Blowing Rock Conference Center
1818 Goforth Road
Blowing Rock, NC 28605
828.295.7813

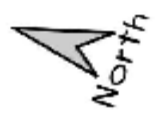
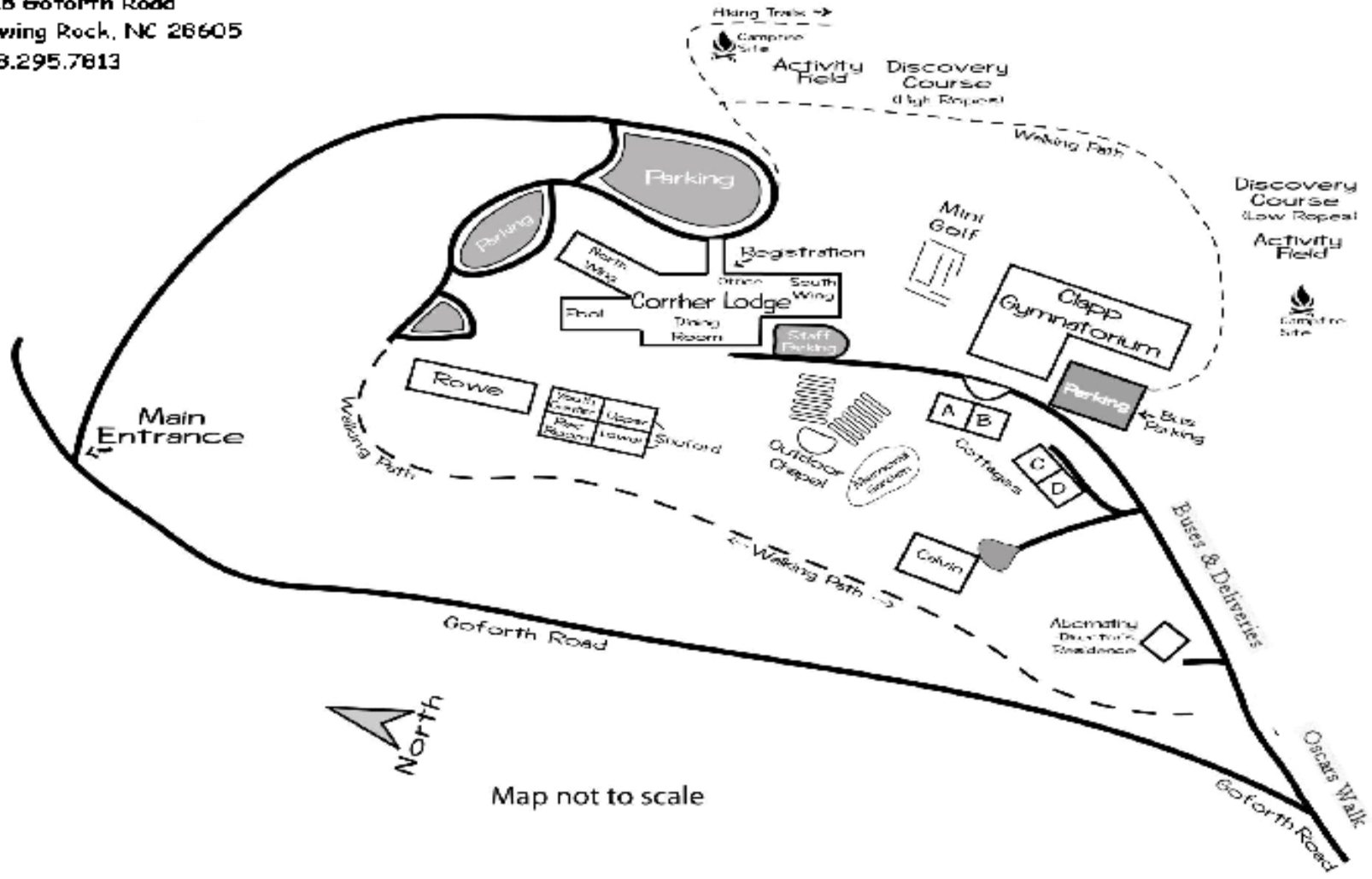

Map not to scale

Corriher Lodge is Blowing Rock Conference Center's principal building and hub of activity. Here you will find the administrative offices, registration desk, dining hall, indoor pool, and meditation chapel, in addition to guest rooms and meeting facilities. Many folks enjoy relaxing in the rocking chairs on our front porch.



There are many pleasant gathering areas for our guests to enjoy quiet conversation and fellowship, from Corriher Lodge's South Lobby with its gas log fireplace, to decks and porches, to small tucked away spots for more intimate conversations.

Each of the 51 lodge guest rooms is comfortably appointed with two double beds and a private bath. Five of the guest rooms are handicapped-accessible. Because of our moderate climate at 4000 ft. above sea level, our buildings are not air-conditioned. Box fans are provided in each bedroom. Wi-Fi is available throughout Corriher Lodge.

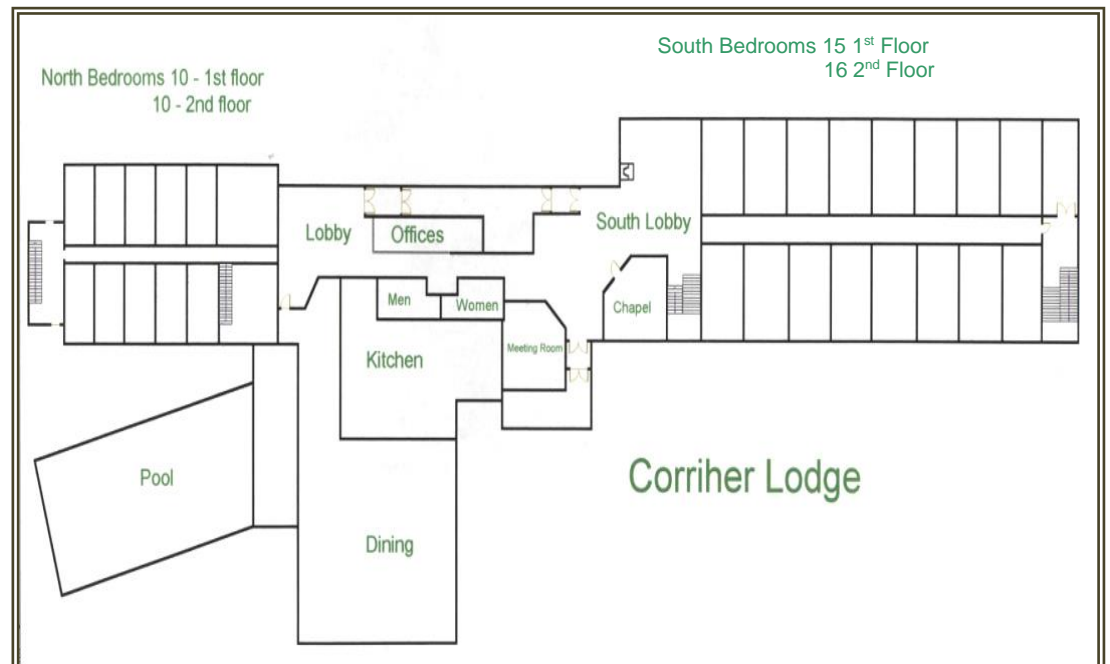



BRCC's Cottages are perfect for small retreats or a family get-away, whether for a fall color-viewing weekend or a week long summer vacation!

Our four cottages are actually two duplex buildings. Each building contains two cottages. One building contains cottages A and B; the other is cottages C & D. Each cottage will accommodate six persons, with one bedroom having a queen bed and the other bedroom with 2 single beds and a bunk bed set. Each cottage's kitchenette is equipped with a 3 burner stove, small oven & refrigerator, microwave, & coffee maker. A "kitchen kit" of pots & pans, dishes and utensils are available upon request. Sheets, pillows, and blankets are provided for beds. Cottages are not air conditioned, but each has a ceiling fan and a floor box fan.

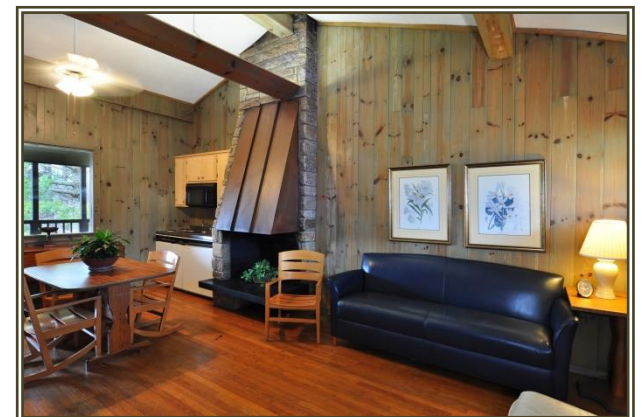
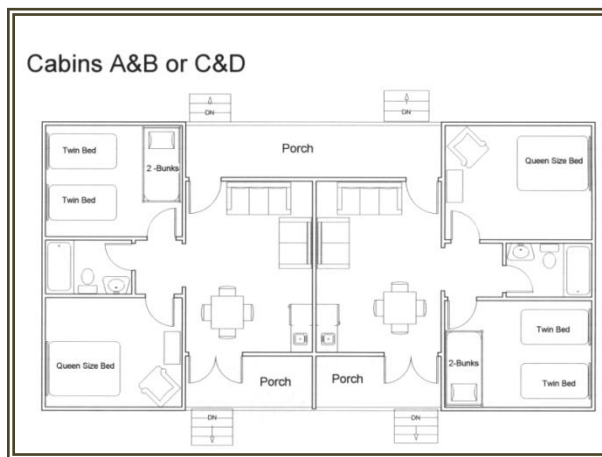

Rowe Dorm will accommodate 80 persons in ten two-bedroom dorm-style units, each bedroom sleeping 4 in bunk beds, with a shared bathroom. There are no cooking facilities in Rowe Dorm.

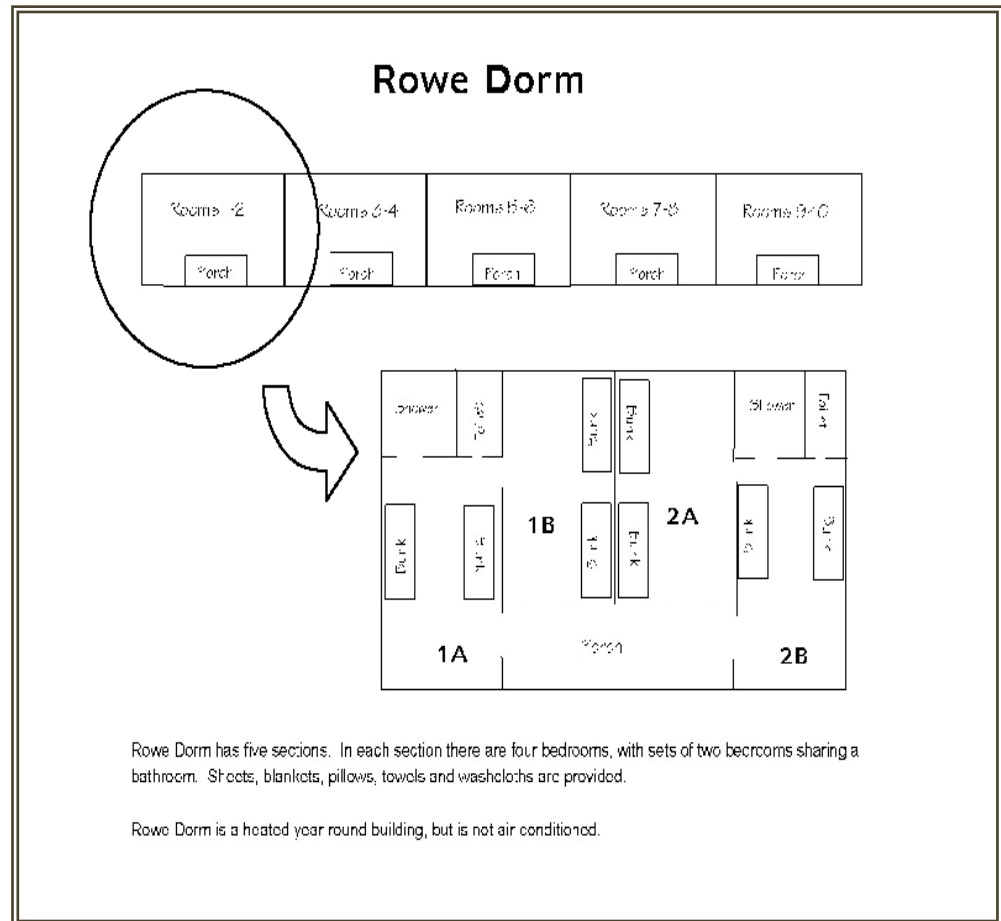

Rowe Dorm has five sections. In each section there are four bedrooms, with sets of two bedrooms sharing a bathroom. Sheets, blankets, pillows, towels and washcloths are provided.

Rowe Dorm is a heated year round building, but is not air conditioned.

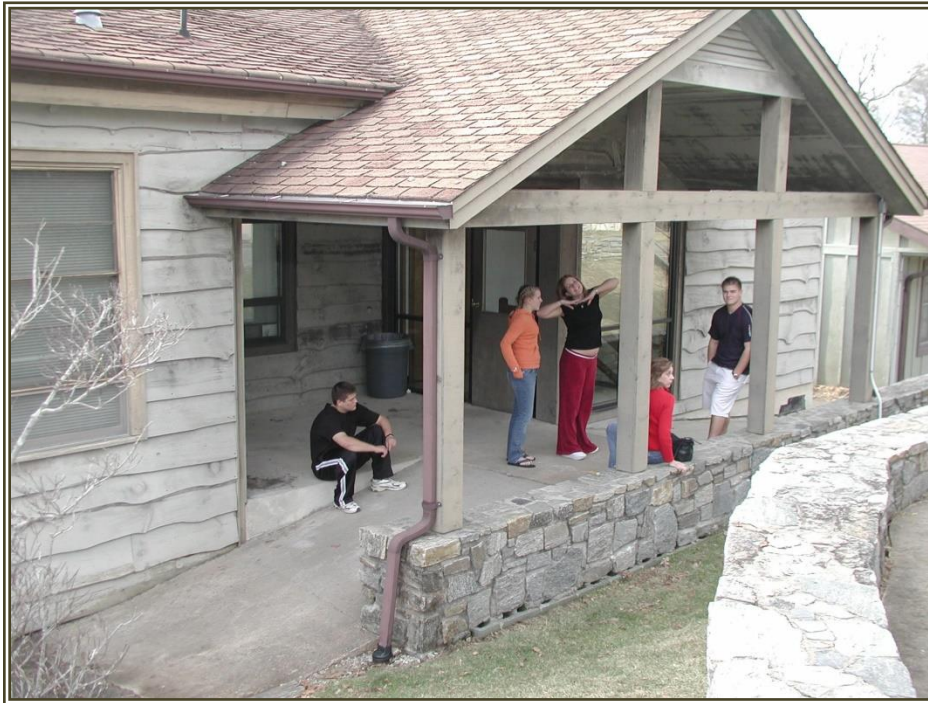

The Southern Conference Youth Center has dormitory-style accommodations for 24-28 guests. Each of the four bedrooms contains three sets of bunks and one trundle bed. There are two bathrooms in the Youth Center, each with two showers, two sinks, and two toilets. There are no cooking facilities in the Youth Center.

Southern Conference Youth Center



The Youth Center will accommodate 24 guests in bunk beds, and each of the 4 rooms also contains a trundle bed, bringing the capacity of the Youth Center to 28. Sheets, blankets, pillows, towels and washcloths are provided.

The Youth Center is a year-round heated facility, but is not air conditioned. There is a box fan provided for each bedroom.

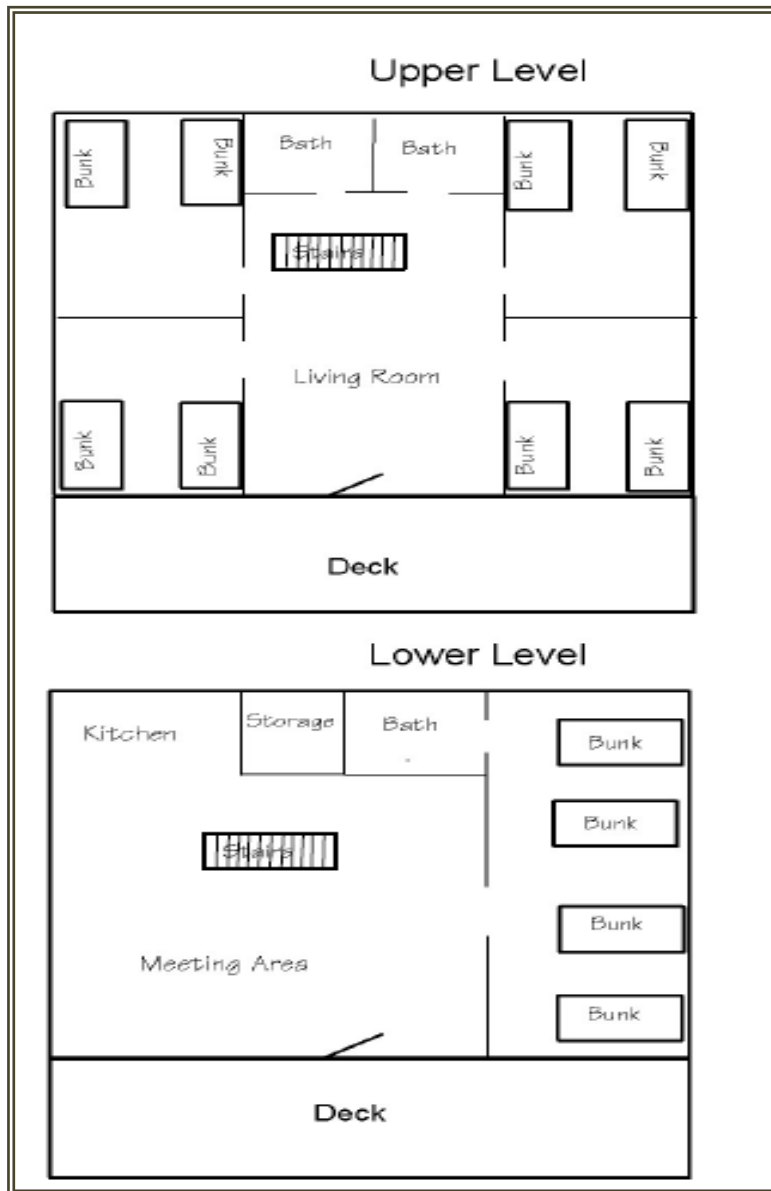

Calvin Cottage is a year round retreat center accommodating 24 guests. Bedrooms are dormitory-style, with bunk beds. The kitchen includes a full size refrigerator and stove. A coffee maker, pots and pans, dishes utensils, potholders, dishtowels, and dishwashing liquid are also provided. The meeting area adjacent to the kitchen contains chairs and tables. Two large decks offer pleasant outdoor space during milder weather. Calvin Cottage is a year round heated retreat center. It is not air conditioned.



Meeting Space Information

A variety of meeting rooms are available at the Blowing Rock Conference Center - some with fireplaces, and others with a smaller, more business-like atmosphere.

Our staff will make every effort to set your meeting space or breakout rooms according to your request, using the Meeting Space Request Form that each group leader is provided. Although meeting spaces are assigned to groups by our staff, we endeavor to match the meeting space with the group's size and program needs.

All meeting spaces have a large screen, smart tv. We can provide sound system, LCD projector, screen, and dry erase board as well as microphones, mic stands, music stands, easels, podiums, CD players, or our 88-key Yamaha keyboard (which does not have a transpose button).

Our staff is available to print, make photocopies, and send faxes.

There is free wireless internet available in all of BRCC's meeting rooms.

BRCC Meeting Rooms

Meeting Room	Location	Dimensions	Square Feet	Wi-Fi	Seating Theater-style	Seating Classroom-style (at 30" X 72" tables)
Lower Conference Room	Corriher Lodge	40 x 32	1280	Yes	60	36
Upper Shuford Hall	Shuford Hall	60 x 30	1800	Yes	150	60
Lower Shuford Hall	Shuford Hall	50 x 28	1400	Yes	120	45
Rec. Room (Southern Conference Meeting Room)	Youth Center	48 x 30	1440	Yes	75	30
Gym Meeting Room	Clapp Gymnasium	23 x 19	437	Yes	20	18
South Conference Room	Corriher Lodge	24 x 21	504	Yes	20	15
Meditation Chapel	Corriher Lodge	20 x 20	400	Yes	20	n/a
Gathering Place	Corriher Lodge	12 x 40	480	Yes	10	n/a
Gym Lobby	Clapp Gymnasium	30 x 40	1200	Yes	20+	n/a
Earnhardt Room	Corriher Lodge (Dining Room)	12 x 24	288	Yes	12	n/a
Gymnasium	Clapp Gymnasium	60 x 100	6000	Yes	350	12

Room dividers are available for either Upper or Lower Shuford.

During our warmer weather months there are several outdoor areas that can serve as meeting or breakout areas, including patios, decks, the Outdoor Chapel, Gazebo and Pavilion.

Upper Shuford Hall



Upper Shuford Hall has a maximum capacity of 150, and is located a few short steps from Corriher Lodge. It is a great location for plenary sessions, worship services and group activities. Choirs enjoy the acoustics of this room.

Upper Shuford Hall is handicap-accessible and features a natural stone fireplace, refrigerator and sink, restrooms, a built-in 5 mic audio system and 2 65" smart televisions, and Wi-Fi.



Lower Shuford Hall

Lower Shuford has a maximum capacity of 120. A large natural stone fireplace serves as the focal point of the room. Nearby restrooms, a refrigerator, and a screen are provided.

A small patio is located just outside the meeting area.

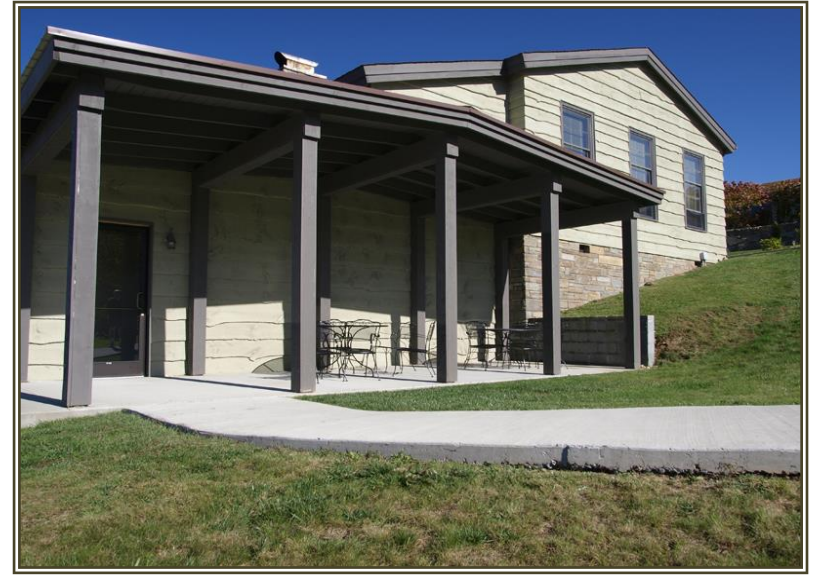

Lower Shuford may be accessed by stairway from Corriher Lodge, or by going around the building and entering the rear of the building, which is handicap-accessible.

Southern Conference Meeting Room

Southern Conference Meeting Room, sometimes referred to as the “Rec. Room”, has a maximum capacity of 75. This meeting room is located directly beneath the Southern Conference Youth Center, and may be accessed via stairway from the Youth Center, or by entering the rear of the building through the handicapped-accessible entry. A refrigerator, microwave oven, and sink/counter area, screen and Ping Pong table are located in this room, and restrooms are just off the hallway near the back entrance.



The Martha Shore Conference Room



Martha's Conference Room, located just off the south lobby of Corriher Lodge, is the perfect spot for a small group meeting or breakout space. The room can seat 20 people theater-style, or up to 15 at tables.

A pull-down screen, large screen smart tv, and wireless internet are available in this room as well as a large, flat-screen, smart tv.



Lower Conference Room

Corriher Lodge's Lower Conference Room is located beneath Leonard Dining Room. The room is carpeted, and is ideal for groups of up to 50 people. Free wireless internet is available. A pull-down screen, full-size refrigerator, countertop and sink, are located in the room. Restrooms are just off the hallway, and there is a patio outside the meeting room.



The Lower Conference Room is accessed either by a stairway from Leonard Dining Room or by exiting the South Corriher Lodge lobby and walking a short distance behind the building via the handicapped-accessible route.

Areas for Worship, Prayer or Contemplation

Meditation Chapel

All our guests are welcome to visit this pretty little chapel in South Corriher Lodge, with its glass block windows and stained glass door. It is a perfect spot for quiet reflection or for intimate worship services or weddings.

The chapel will seat 20-25, and is located just off the South Lobby in Corriher Lodge. There is a piano available for your use.

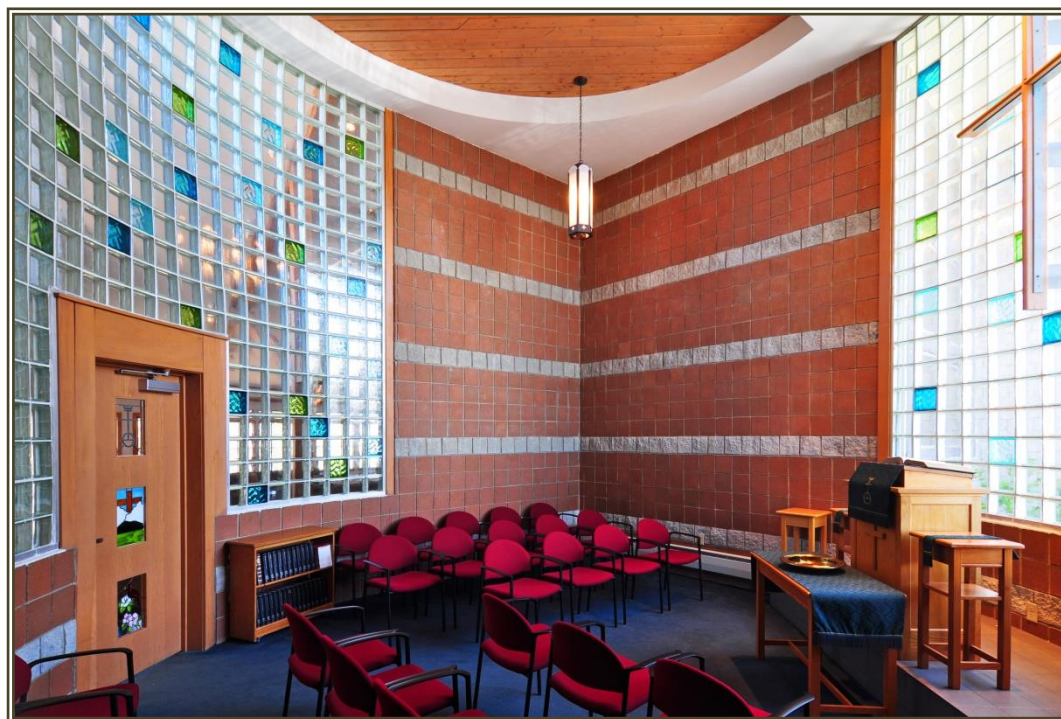
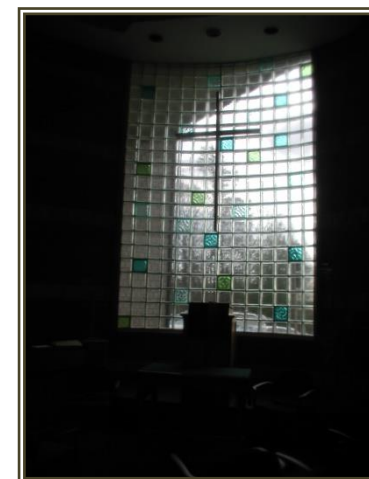
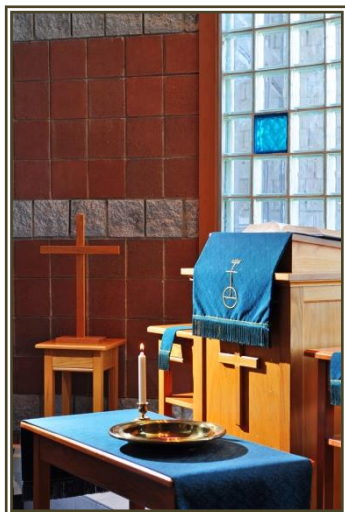

Shuford Outdoor Chapel



The Shuford Outdoor Chapel is perfectly suited for your morning watch or evening vesper services.

This pleasant outdoor gathering area will seat 90 people, but is just as suitable for solitary meditation or a small-group discussion, and is located off the northwest side of Corriher Lodge.



The Yvonne Handschuh Brown Memorial Garden

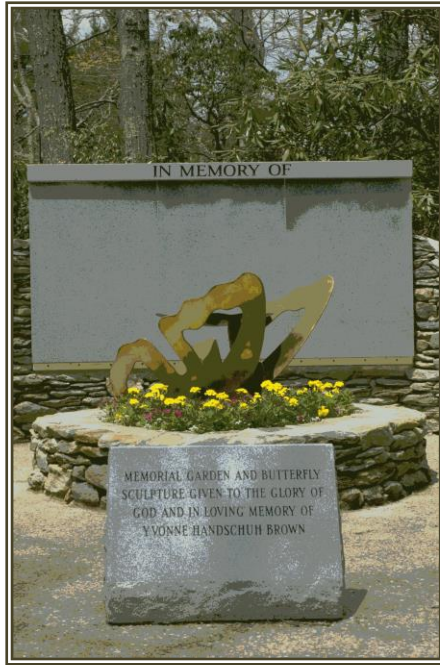

Our Memorial Garden is set in a lovely location amongst the rhododendron between Shuford Cottage and the Shuford Outdoor Chapel, just a short walk from Corriher Lodge. The Yvonne Handschuh Brown Memorial Garden and the butterfly sculpture are a gift from the family of Mr. James Brown of Burlington, in remembrance of his wife, Yvonne.

The primary purpose of the BRCC Memorial Garden is to provide a place for memorials and/or the interment of ash remains for friends of the BRCC, their families and other interested persons.

The Memorial Garden is also intended to be a place for rest, meditation, and prayer where persons can go in the beauty of God's world to experience the spiritual presence of "those who have passed this way before." The Memorial Garden is a quiet spot that is easily visited, yet set apart from view.



Leonard Dining Room



Leonard Dining Room, with its spectacular view of Grandfather Mountain and beautiful stone fireplace, is located in Corriher Lodge. We take pride in offering tasty home-style meals, served buffet-style in a friendly atmosphere for groups of 20-175.

BRCC offers groups the flexibility to decide which meals they would like in their meal package. We serve breakfast, lunch and dinner, and also offer sack lunches or suppers for groups on the go.

Groups wishing to have break refreshments or snacks prepared for them are sent an order form in advance of their event, with choices for food and beverage items in different price ranges to fit any budget.

Meal Times

Breakfast	8:00-8:45
Lunch	12:00-12:45
Dinner	6:30-7:15



On-Site Recreation

The Blowing Rock Conference center offers a variety of recreation opportunities such as basketball or volleyball in our gymnasium, a mini-putt golf course, bean-bag toss games, and walking paths. Our indoor pool is available Memorial Day weekend through Labor Day weekend. A large activity field is available for group games, and we have two camp fire areas with benches, available May – October. A half-court basketball area is located just outside Clapp Gymnasium, and outdoor volleyball is available during our June – August summer season.

Our high ropes course, Discovery, is available year-round for half or full day programs! The Discovery Course is facilitated by our partner organization, Blue Ridge Learning Centers, whose instructors are professional outdoor educators with many years of experiential based facilitation. Blue Ridge Learning Centers offers programs for all ages and walks of life and can meet the needs of any group using various resources on the grounds as well as the climbing wall in the gymnasium.

For more information about Blue Ridge Learning Centers and their programs, visit their website at www.brlc.org or call them at 828-265-5467.

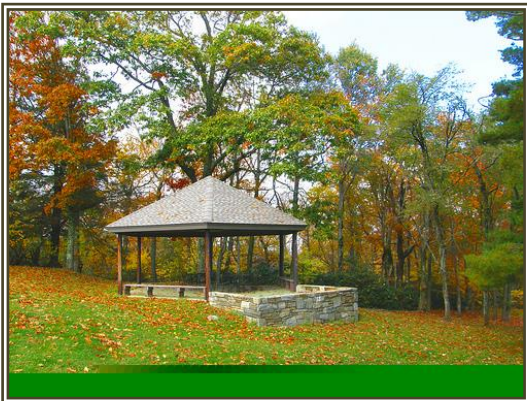

The **pavilion** (*pictured left*) is located between the Corriher Lodge parking lot and the Discovery Course.

The Ken Clapp Gymnatorium

This multi-purpose building has a full size gymnasium, restrooms, a large lobby and a meeting room that can accommodate 20 people. The gymnasium is a popular spot for basketball and volleyball. The climbing wall in the gymnasium is available for group programs through High Gravity Adventures. For information about availability and pricing, call them at 828-265-0602.

Our gymnasium can also be set up as a large group meeting space that can accommodate up to 350 people. Wi-Fi is available in the building. Set up with staging and a sound system, it becomes a very effective venue for worship, skits or plenary sessions.

A half-court basketball is just outside the covered activity field nearby is available areas with benches are located just a short



Gymnatorium and the grass-for group games. Two campfire walk away.



Swimming Pool

BRCC's indoor heated swimming pool is open June 1-August 31. Because BRCC does not provide a lifeguard, adult supervision is required for all youth groups/children. **Reservations must be made in advance.**



2020 Rates

Lodging

BRCC has three levels of lodging. Our 51 hotel-style rooms, our family cottages, and our youth lodging of bunk beds in various units. We also offer youth rates in the lodge rooms.

Corriher Lodge: *Rates are per room, per night and **do not include meals. All rooms have two, extra-long, full-size beds and a private bathroom.***

NON-PRIME SEASON: January 1 – June 14 and November 16 – December 31

WEEKEND AND MIDWEEK RATES. [2 NIGHT MINIMUM JANUARY & FEBRUARY WEEKENDS](#)

North Corriher Lodge

<u>Single</u>	<u>Double</u>	<u>Triple</u>	<u>Quadruple</u>
\$80.00	\$100	\$120.00	\$135.00

South Corriher Lodge

<u>Single</u>	<u>Double</u>	<u>Triple</u>	<u>Quadruple</u>
\$85.00	\$110.00	\$130.00	\$145.00

PRIME SEASON: June 15- November 15

WEEKEND RATES. [2 NIGHT MINIMUM ON WEEKENDS \(Must book Friday and Saturday night\)](#)

North Corriher Lodge

<u>Single</u>	<u>Double</u>	<u>Triple</u>	<u>Quadruple</u>
\$100	\$115.00	\$135.00	\$150.00

South Corriher Lodge

<u>Single</u>	<u>Double</u>	<u>Triple</u>	<u>Quadruple</u>
\$105.00	\$120.00	\$140.00	\$155.00

MID-WEEK RATES (Sunday – Thursday nights)

North Corriher Lodge

<u>Single</u>	<u>Double</u>	<u>Triple</u>	<u>Quadruple</u>
\$80.00	\$95.00	\$115.00	\$130.00

South Corriher Lodge

<u>Single</u>	<u>Double</u>	<u>Triple</u>	<u>Quadruple</u>
\$85.00	\$100.00	\$120.00	\$140.00

Please note: Youth rates for the lodge are \$38 per person per night, double or triple occupancy. Youth rate for quadruple occupancy is \$30 per person. Youth rates for the cottages are \$38 per person, minimum 4 per cottage. Chaperone/coach rates for a single lodge room are \$50 per night.

Family Cottages

A two night minimum applies for weekends in January, February, and mid-June through mid-November.

Nightly Rate, per Cottage: \$165 per night *Rates are year round and **do not include meals.***

Special Weekly Rate, per Cottage: \$800.00 Friday to Friday; each additional night \$110.00

Youth Lodging in bunk beds

A two night minimum applies for our busier weekends of January and February; June – October.

\$35 per person for 1 night
\$30 per person per night for multiple nights

*Rates are year round and **do not include meals.***

Rowe Dorm (80 beds in 10 units)

Southern Conference Youth Center (28 beds in 4 bedrooms)

Calvin Cottage (26 beds in 5 bedrooms with a full kitchen) *Minimum charge of \$390 per night.*

Meals

We do not require groups to enjoy meals with us, but we are known for serving delicious, fresh food! The convenience of having our staff prepare your meals and handling clean-up is a priceless time-saver, as well as eliminating the need to coordinate all the details and make separate payments to outside caterers. It also helps us to tread lightly on our planet without the use of disposables. Due to health code restrictions, our commercial kitchen is only available to our certified staff. As we are a dining hall and not a restaurant, we do require advance registration by at least two weeks for the scheduling of meals.

Rates are per person. There is no charge for children under the age of 5 years old. Sales tax of 6.75% may be applicable and is not included in the prices listed below. Three daily meals for adults is \$32.75 and \$21.50 for children.

	<u>Age 5-12</u>	<u>Age 13+</u>
Breakfast	\$6	\$9.25
Lunch	\$7	\$11
Dinner	\$8.50	\$12.50
Sack lunch or supper	\$9	\$9

Miscellaneous Food Services

Additional beverages and refreshments throughout the day and evening are available upon request for additional cost. Examples include:

- | | |
|--|--|
| <ul style="list-style-type: none">• mid-morning pastries/muffins and coffee/tea• mid-afternoon snacks and sodas• late night pizza or popcorn• Veggies and dip platter | <ul style="list-style-type: none">• cut fruit platter• cheese & crackers• s'mores makings for your campfire• hot chocolate and cookies• coffee and hot tea |
|--|--|

Conference/Facilities Fee

This fee is a per person charge for all who gather on our grounds with a group. This fee covers use of our grounds/facilities, one meeting space, setup, and equipment. A portion of this fee will be applied to Blowing Rock Conference Center's Endowment Fund. The charge is \$10.00 for the first day and \$2 per each additional day, based on our standard check-in and departure times. Early arrival and late departure may incur an additional charge of \$1 per person per day of extended use. \$20.00 per person maximum. 6.75% sales tax not included. Additional meeting and breakout spaces may incur additional charges and are subject to availability.

Length of Event	Conference Fee for those over 5 years old
One Day Event	\$10.00 per person
Two Day Event	\$14.00 per person
Three Day Event	\$16.00 per person
Four Day Event	\$18.00 per person
Five Day Event	\$20.00 per person
Six Day Event	\$20.00 per person

Audio Visual Aids and Other Program Equipment and Services

Audio-visual equipment is available for each meeting room. The charge for equipment is covered by the conference/facility fee. Please contact BRCC in advance to request these items.

Smart TV
Sound system
LCD projector for your laptop
Easel/dry erase board

Projection Screen
DVD Player
CD player
Podium

Banquet/Reception Meals Will be priced according to menu selected

	<u>Age 5-12</u>	<u>Age 13+</u>
Banquet/Reception meal (per person)	Starting at \$13	Starting at \$17

All groups who are not overnight guests will be charged banquet rates. Other options such as punch and appetizers are available. Per person price for special requests are based on food and beverage choices. We do not provide alcoholic beverages. All meals are served buffet-style. Final payment is due two weeks prior to the meal. Tablecloths are available for an \$8.00 per table fee. Additional rental fee for the dining room or equipment may apply. If additional meeting spaces are needed, additional fees may apply.

Meeting Spaces

Priority for meeting spaces is given to our overnight guests. Day use of meeting spaces is available only when it will not detract from our groups on retreat. The charge for day use of a meeting space starts at the costs shown below. Additional charges for set up and equipment may apply. Additional breakout spaces will be charged at half price. All meeting spaces have Wi-Fi.

Leonard Dining Hall	\$1,500
Upper Shuford Hall	\$1000
Lower Conference Room	\$600
Lower Shuford Hall	\$600
Rec Room	\$500
Martha's Conference Room	\$250
Gym Meeting Room	\$200
Picnic Pavillion (no Wi-Fi) Power available	\$125 for up to 4 hours

Dedicated Places for Worship

These are provided free of charge to overnight guests and UCC churches; for all others, a rental fee applies.
Reservations are required.

	<u>Capacity</u>	<u>Rate</u>
Shuford Outdoor Chapel	90	No charge to guests. For others up to 25 people: \$100*; 26+: \$150*
Meditation Chapel	25	No charge to guests. For others \$125*

On-Site Program Facilities

[These amenities are available by reservation only](#) to guests.

Gymnasium	no charge
Swimming pool (available June 1-August 30)	no charge
Outdoor volleyball and basketball	no charge
Cornhole boards	no charge
Picnic Pavilion	no charge
Camp Fire (Weather permitting)	\$25 fee per campfire

Blue Ridge Learning Center (Ropes course) Available On-Site

We offer team and leadership building activities on our grounds through our partnership with Blue Ridge Learning Center. You may book these professionals to enhance your retreat.

Facilities on our grounds:

Discovery Course (High Ropes Course)

Indoor Climbing Wall

Group Interaction Course Activities rain or shine

Available by reservation only. For information on rates and availability contact Blue Ridge Learning Center:

828-265-5467 or info@brlc.org

<http://www.brlc.org/high-ropes/>

Rates starting at \$20 per person.

Miscellaneous Information

What to bring: BRCC supplies bed linens (sheets, pillowcases, pillows and blanket) and towels (bath towel and washcloth). You will need to bring your own toiletries, hairdryers, irons, etc.

Making your reservation: Once you have decided on a date and where you would like to stay, our Reservations Staff will be happy to help you finalize your reservation plans. You will need to supply a mailing address for your church or organization, telephone number, and other contact information. You'll be asked to tell us how many people will be in your group, how many rooms you wish to reserve, and which meals you want to schedule. BRCC requires a deposit in order to confirm your reservation. Deposits are due within two weeks after you have made your reservation and are non-refundable. Deposits are applied towards the final bill and are based on the following guidelines:

Corriher Lodge	\$50.00 per room reserved
Cottages A, B, C or D	\$100.00 per cottage reserved
Calvin Cottage	\$250.00
Rowe Dorm	\$50.00 per room
Youth Center	\$200.00

Payments: the final payment for first time groups is due 10 days prior to the beginning of the event; adjustments will be made at the time of arrival if there has been an increase in the number of participants, and an additional invoice will be prepared. For returning groups, payment is due upon your arrival, unless other arrangements have been made in advance (see below). We accept cash and checks.

A returning group may request, in advance, for a later payment and may take the invoice or have us email it to them, in which case the balance is due 10 days from the date of the event's ending. A 1.5% surcharge is added every seven days after that date until we receive your payment.

Refunds and Cancellation Policies: If a group cancels prior to their deposit due date and has already paid their deposit, a refund of that amount minus a \$10.00 processing fee will be granted.

Once the deposit due date has passed, deposits are non-refundable; however, groups that cancel with at least a sixty day notice from their arrival date are given an opportunity to roll-over their reservation and deposit one time within a twelve-month period.

Groups who have reserved Corriher Lodge rooms have the opportunity to drop rooms without penalty no less than 60 days prior to their arrival; that date is stated in the reservation contract. After that date if the number of rooms dropped exceeds more than 10% of the total number of rooms reserved, there is a \$50.00 penalty per each dropped room. A group may add rooms at any time, based on availability.

Inclement Weather Policy: If the NC State Highway Patrol deems road conditions to be too dangerous for travel, we will work with groups to reschedule within a twelve-month period. The entire amount of the deposit thus far received by BRCC will be applied to that future bill. Or, if the group chooses to proceed with their retreat and arrive the next day after road conditions have improved, the group would be charged only for overnights and meals taken.

Meals: Group leaders are required to contact BRCC two weeks prior to their arrival with a guaranteed number of persons taking meals. The group's invoice will be prepared using that number as the minimum for meal charges. The group will be charged in full for meals reserved and not taken. If the group leader fails to call BRCC with a guaranteed number, the estimated number of participants at the time of booking, as stated in the group's reservation contract, will be used as a minimum.

How to Contact Us

Our Reservations Office is open Monday – Friday from 9 a.m. until 4:30 p.m.

Phone: 828-295-7813

Fax: 828-295-5066

Email: info@brccenter.org