

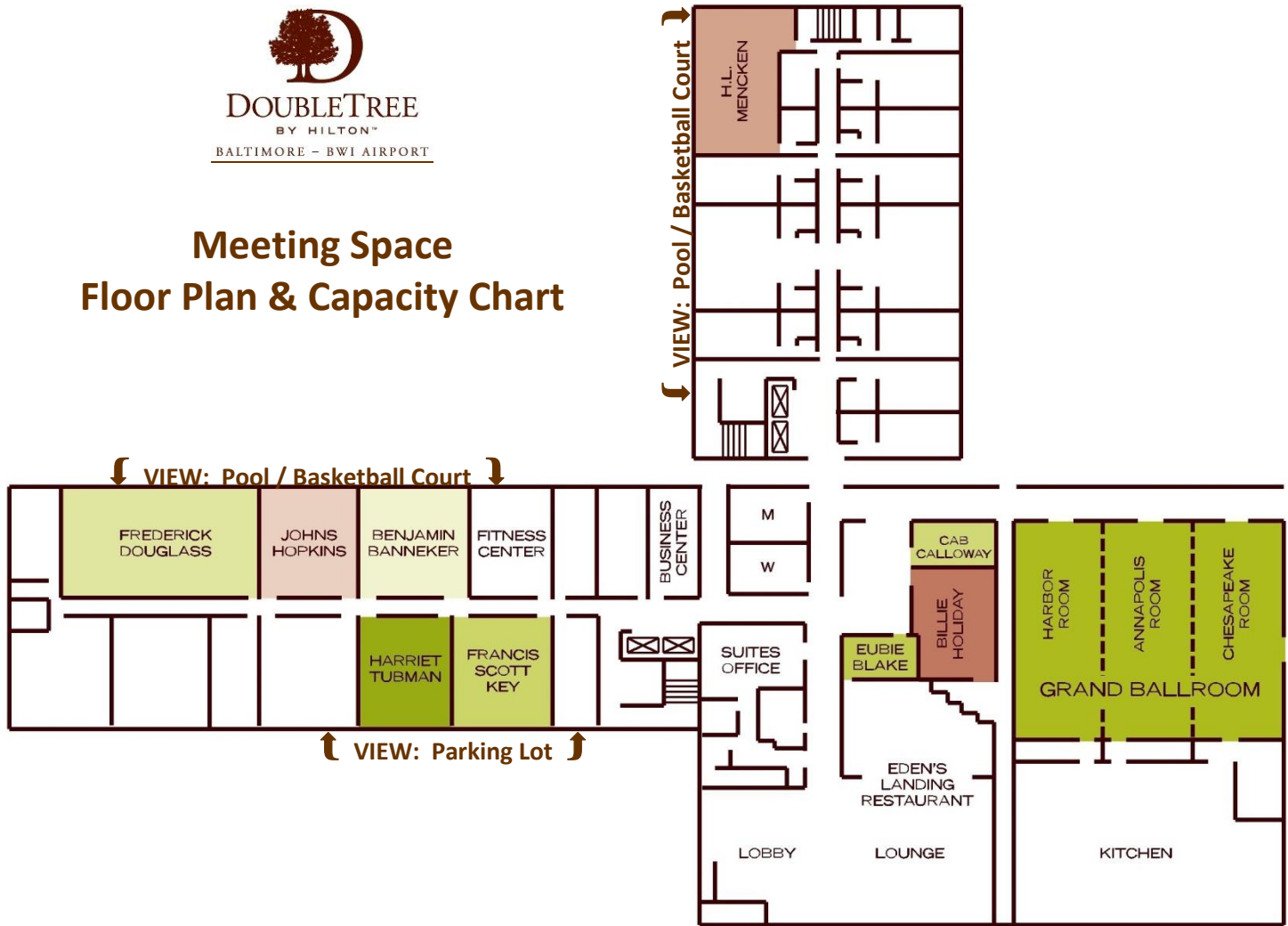

## Meeting Space Floor Plan & Capacity Chart



Name of Room	Dimensions	Total Sq. Ft.	Ceiling Ht.	Theatre	Classroom	Rounds	U-Shape	Conference	Crescent
Grand Ballroom	5025	88' x 63'	10'	600	300	300	-	-	180
Harbor	1675	26' 7" x 63'	10'	200	100	100	50	52	60
Annapolis	1675	26' 7" x 63'	10'	200	100	100	50	52	60
Chesapeake	1675	26' 7" x 63'	10'	200	100	100	50	52	60
Frederick Douglass	980	20' x 49'	8'	80	60	60	36	38	36
HL Mencken	805	36' 5" x 20' 5"	8'	60	48	50	28	30	30
Billie Holiday	772	22' 6" x 35' 8"	10'	60	44	50	28	30	30
Harriet Tubman	492	20' x 24' 6"	8'	40	28	40	20	22	24
Johns Hopkins	492	20' x 24' 6"	8'	40	28	40	20	22	24
Benjamin Banneker	492	20' x 24' 6"	8'	40	28	40	20	22	24
Francis Scott Key	492	20' x 24' 6"	8'	-	-	-	-	14	-
Cab Calloway	290	22' 1" x 13' 10"	10'	-	-	-	-	12	-
Eubie Blake	323	23' 6" x 14'	10'	-	-	-	-	12	-

### Pre-function Space

Approx. 20' x 40' 800 sf

Accommodates approx. 50-80 ppl for a Reception. Also appropriate for Vendors (aprox 5), Lunch Buffet (attendees eating in mtg rm), Registration

### Eden's Landing

Accommodates (65) guests with existing seating arrangement

### Courtyard (outdoor space)

Accommodates about 100 ppl – great for barbeque!

(setup fees apply for outdoor events. Hotel reserves the right to move event indoors in the event of inclement weather)