

STUDENT CENTER COMPLEX

Comprised of seven unique locations.

The University of Miami Student Center Complex (SCC) encompasses seven different locations that serve students, university departments, alumni, and friends of our community. The Student Center Complex's facilities comprise indoor and outdoor event venues, including the: Breezeway, Edward T. Foote II University Green, Lakeside Patio & Stage, Norman A. Whitten University Center and Pool, Rock Plaza, U Statue, and Donna E. Shalala Student Center.

The Student Center Complex is conveniently located near Miami International Airport and downtown Miami with a variety of hotel accommodations nearby. In the center of the University of Miami campus in Coral Gables, The City Beautiful, the SCC is the ideal place for meetings and gatherings of all sizes.



DONNA E. SHALALA STUDENT CENTER & NORMAN A. WHITTEN UNIVERSITY CENTER

The perfect location for your upcoming event.

Both the Donna E. Shalala Student Center and the Norman A. Whitten University Center provide flexible meeting and event space, making it the perfect place for your next conference or event. Both venues are located on the shores of Lake Osceola.

The Donna E. Shalala Student Center (SC) is equipped with a full array of multimedia capabilities and stylish environments. Designed by renowned Miami-based Arquitectonica, the SC showcases the firm's signature style – incorporating a dramatic, expressive modernism. Offering a variety of spaces, the SC can host events for 10 to 1,000 people.

The Norman A. Whitten University Center (UC) is the site of smaller meeting rooms and event spaces. Many spaces are flexible and may be set up in banquet, theater, conference, and classroom style to best suit your event needs.

The SCC offers a wide selection of settings from which to choose. Whether you are looking for a casual gathering space in the UC or prefer the more formal atmosphere of the SC, the venues at the Student Center Complex can accommodate your needs.



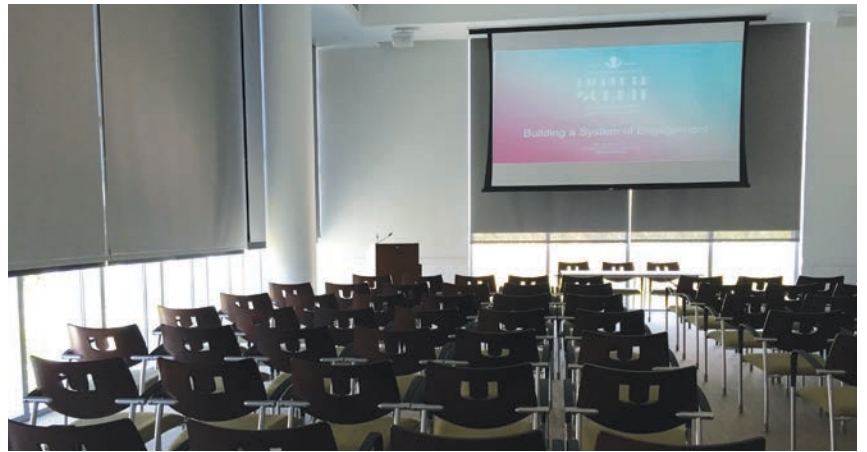
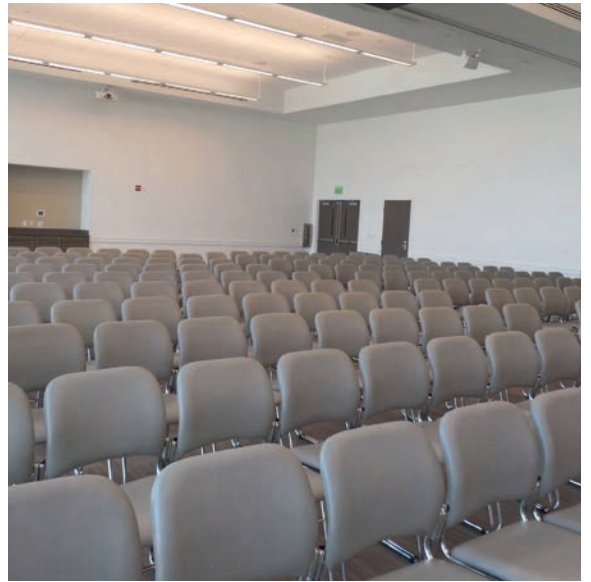



MEETINGS & GATHERINGS

The Student Center Complex has over 225,000 square feet of interior meeting space.

The Shalala Student Center and the Whitten University Center provide groups with excellent customer care and beautiful spaces to create memorable events and productive meetings. Both facilities have rooms that offer personal and comfortably-sized meeting and event space.

The meeting rooms at the Shalala Student Center are equipped with the latest in audiovisual (A/V) capabilities. They include high-speed wireless internet access, LCD flat-panel monitors or projectors and screens, audio equipment, and available A/V assistance.

MEETINGS

Norman A. Whitten University Center
(UC)



Room	Sq. Ft.	Theatre	Banquet	Conference	Classroom
Biscayne 1220	672	50	40	25	n/a
International Lounge	4,420	150 “as is”	n/a	n/a	n/a
Lower Lounge	5,021	150 “as is”	n/a	n/a	n/a
Meeting Room 2300 H	554	45 fixed	n/a	n/a	n/a
Meeting Room 2300 J	503	45	24	25	18
StormSurge	2,942	75	80	50	66

& GATHERINGS



Donna E. Shalala Student Center
(SC)

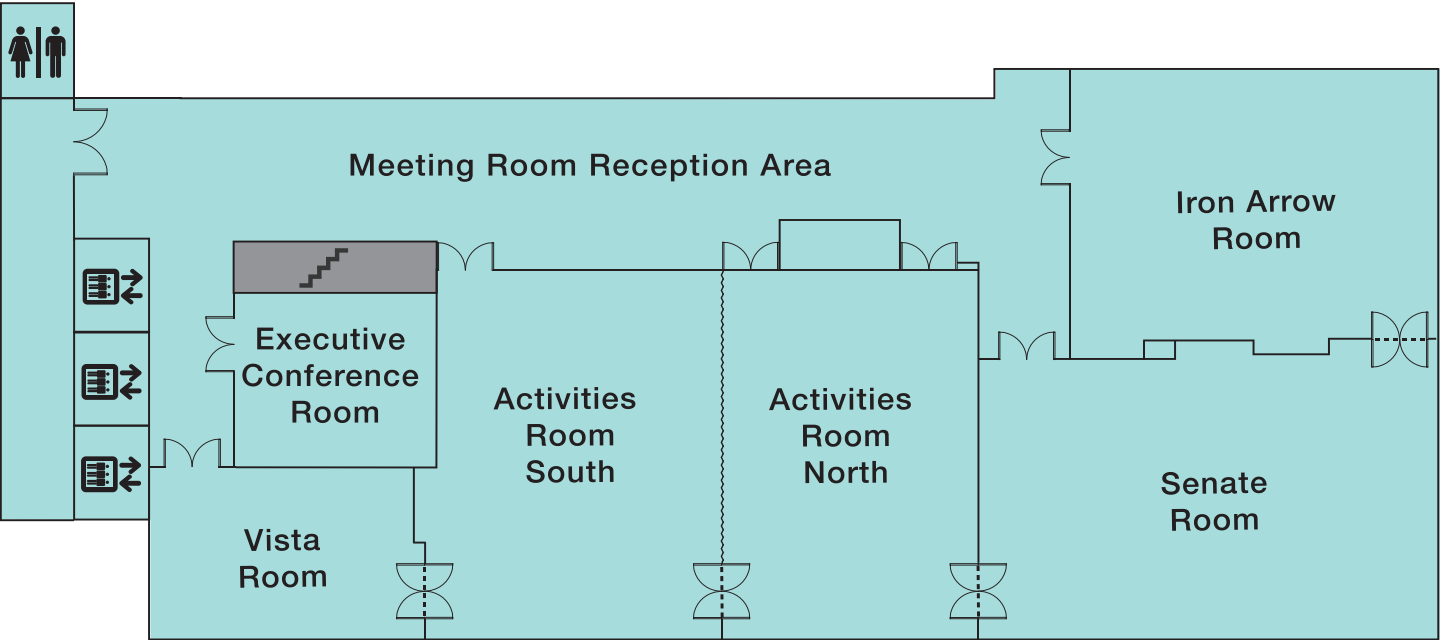

Room	Sq. Ft.	Theatre	Banquet	Conference	Classroom
Activities Room (Combined)	2,482	250	120	64	96
Activities Room North	1,292	101	48	40	48
Activities Room South	1,190	101	48	40	36
Executive Conference Room	384	n/a	n/a	16 fixed seating	n/a
Iron Arrow Room	1,251	99	52	40	54
Meeting Room Reception Area	1,886	n/a	n/a	n/a	n/a
Senate Room	1,538	n/a	n/a	65 fixed seating	n/a
Vista Room	553	30	16	22	18





CELEBRATIONS, CONFERENCES & LARGE EVENTS

Meeting and event space is located on the top floor (third) with stunning views of Lake Osceola and the University of Miami campus.

From elegant wedding receptions to business conferences, every unique event is tailored for the client. Depending on your needs, you may select from the Shalala Student Center's Grand Ballroom, Lakeview Lounge, Third Floor Mezzanine, and Lakeview Terrace.

Located on the shores of Lake Osceola, the Grand Ballroom's flexible space options make it the perfect place for your next conference or special event. The Grand Ballroom is approximately 10,000 square feet of pillar-free event space, which can be divided into smaller spaces with the use of retractable walls. Make your South Florida event a memorable one at the Shalala Student Center.

CELEBRATIONS, CONFERENCES

ACCOMPANYING VENUES

The areas by the Grand Ballroom are the ideal spaces for registration, cocktails, silent auctions, exhibitions, coffee or lunch breaks, and more.

LAKEVIEW TERRACE

The Shalala Student Center's covered outdoor balcony has connecting entranceways to both the Third Floor Mezzanine and the Lakeview Lounge. With panoramic views of Lake Osceola and the University of Miami Campus, the terrace provides a variety of customized setups from intimate dining space to large cocktail parties. The Lakeview Terrace is the perfect outdoor area for entertaining and socializing.

LAKEVIEW LOUNGE

The Lakeview Lounge has floor-to-ceiling windows with scenic views of Lake Osceola. All windows have high-performance glazing and sun shades. This venue is adjacent to the Grand Ballroom, Third Floor Mezzanine, and Lakeview Terrace which makes it the perfect location for pre- or post-function events. The Lakeview Lounge is most commonly used for receptions before and after events and meeting breaks during conferences.



& LARGE EVENTS

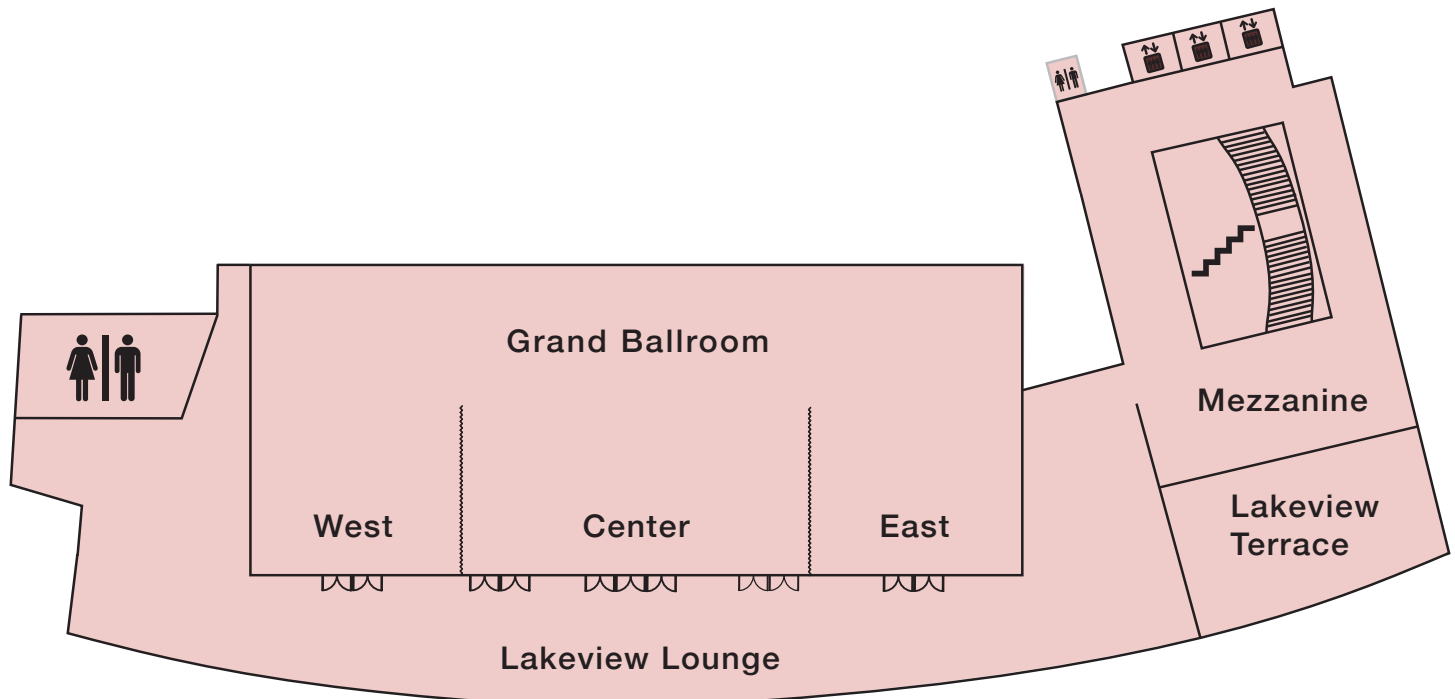

Room	Sq. Ft.	Theatre	Banquet	Conference	Classroom
Grand Ballroom Combined	9,929	1,080	584	n/a	432
Grand Ballrooms East and Center or West and Center	7,217	750	424	n/a	336
Grand Ballroom Center	4,505	450	240	100	192
Grand Ballroom East or West	2,712	270	120	76	120
Lakeview Terrace	1,554	n/a	50	100 reception	n/a
Lakeview Lounge and Grand Ballrooms	15,694	n/a	n/a	n/a	n/a
Lakeview Lounge and Third Floor Mezzanine	9,231	n/a	n/a	n/a	n/a
Lakeview Lounge	5,765	n/a	n/a	450 reception	n/a
Lakeview Lounge, Grand Ballroom Combined, Mezzanine, and Lakeview Terrace	20,714	n/a	n/a	n/a	n/a



BREEZEWAY

The Breezeway, a covered walkway connected to the Whitten University Center, is central to the campus community. Student organizations and UM departments often showcase their events and clubs in the Breezeway. It is also an ideal location for selling goods or promoting services beneficial to University of Miami students.



EDWARD T. FOOTE II UNIVERSITY GREEN

This expansive, manicured lawn in the main section of campus is often the location of concerts and fairs. With walkways from all parts of campus, it's hard to miss an event held at this area.



LAKESIDE PATIO STAGE

The fantastic Florida weather makes the Lakeside Patio Stage a favorite spot. It's been home to many major concerts and events. The performance stage is fully equipped with sound and lighting systems. The Lakeside Patio Stage links the Whitten University Center and the Shalala Student Center along Lake Osceola. The Patio Stage has amazing views of both Lake Osceola and the double-Olympic sized pool.



ROCK PLAZA AND U STATUE

The Rock Plaza and the U Statue are centrally located in the heart of the University of Miami campus. The Plaza is a popular location for retail promotions, events, and picture taking.



OUTDOOR VENUES

Take advantage of the subtropical location at one of the six outdoor locations.

The Student Center Complex outdoor venues have beautiful views of either Lake Osceola or the picturesque University of Miami campus. These locations include the Breezeway, Edward T. Foote II University Green, Lakeside Patio Stage, Rock Plaza and U Statue, and Pool.



PREFERRED CATERERS

We are proud to offer a select list of outstanding preferred caterers. Our preferred caterers have an established relationship with the Student Center Complex and are familiar with the facilities and our policies and procedures.

Visit miami.edu/scc for the list of preferred caterers.



NAMING OPPORTUNITIES

Imagine your company, foundation or family enjoying the recognition that comes with your name honored for generations in the Student Center Complex. For information about naming opportunities, please contact the Division of University Advancement at 305-284-5600.



BOOK AN EVENT, MAKE A DIFFERENCE

Green U is helping the University of Miami, and the community grow greener every day. Green U is focused on integrating greater environmental sustainability throughout our venues.

As a technologically advanced venue, the Shalala Student Center has digital signage to reduce paper waste. Automated energy savers that conserve energy by turning off lights in unused rooms.



All Student Center Complex venues are equipped with water bottle refilling stations, single-stream recycling, and recycled paper products. Additionally, the Shalala Student Center achieved Leadership in Energy and Environmental Design (LEED) Silver Certification. LEED buildings conserve energy and water and reduce waste sent to landfills.

Located just a few minutes drive from Miami International Airport and a short walk from a Metrorail station (University stop), getting to the Student Center Complex is easy. The SCC can arrange the rental of a nearby secure parking garage or valet service. For a printable version visit: miami.edu/SCCdirections.

Directions to Pavia Parking Garage

5615 Pavia Street • Coral Gables, FL 33146

From the north:

Take I-95 south to US 1/South Dixie Highway and continue to Stanford Drive

Turn right on Stanford Drive

Turn left immediately after the Gate House onto Levante Avenue

Take the first right towards the entrance of Pavia Garage (garage is on the left)

From the south:

Travel north on US 1/South Dixie Highway and continue to Stanford Drive

Turn left on Stanford Drive

Turn left immediately after the Gate House onto Levante Avenue

Take the first right towards the entrance of Pavia Garage (garage is on the left)

Directions to Shalala Student Center

For drop-offs or for events with valet service

1330 Miller Drive • Coral Gables, FL 33146

From the north:

Take I-95 south to US 1/South Dixie Highway and continue to Stanford Drive

Turn right on Stanford Drive

At the next light, turn left on Ponce de Leon Blvd.

Turn right on San Amaro Drive

Continue to traffic circle, use first exit to Miller Road

Turn right on Miller Drive

The Shalala Student Center is on the right

From the south:

Travel north on US 1/South Dixie Highway to Red Road (57th Avenue)

Turn left on Red Road

Turn immediately right on Ponce de Leon Boulevard

Turn left on San Amaro Drive

Continue to traffic circle, use first exit to Miller Road

Turn right on Miller Drive

The Shalala Student Center is on the right

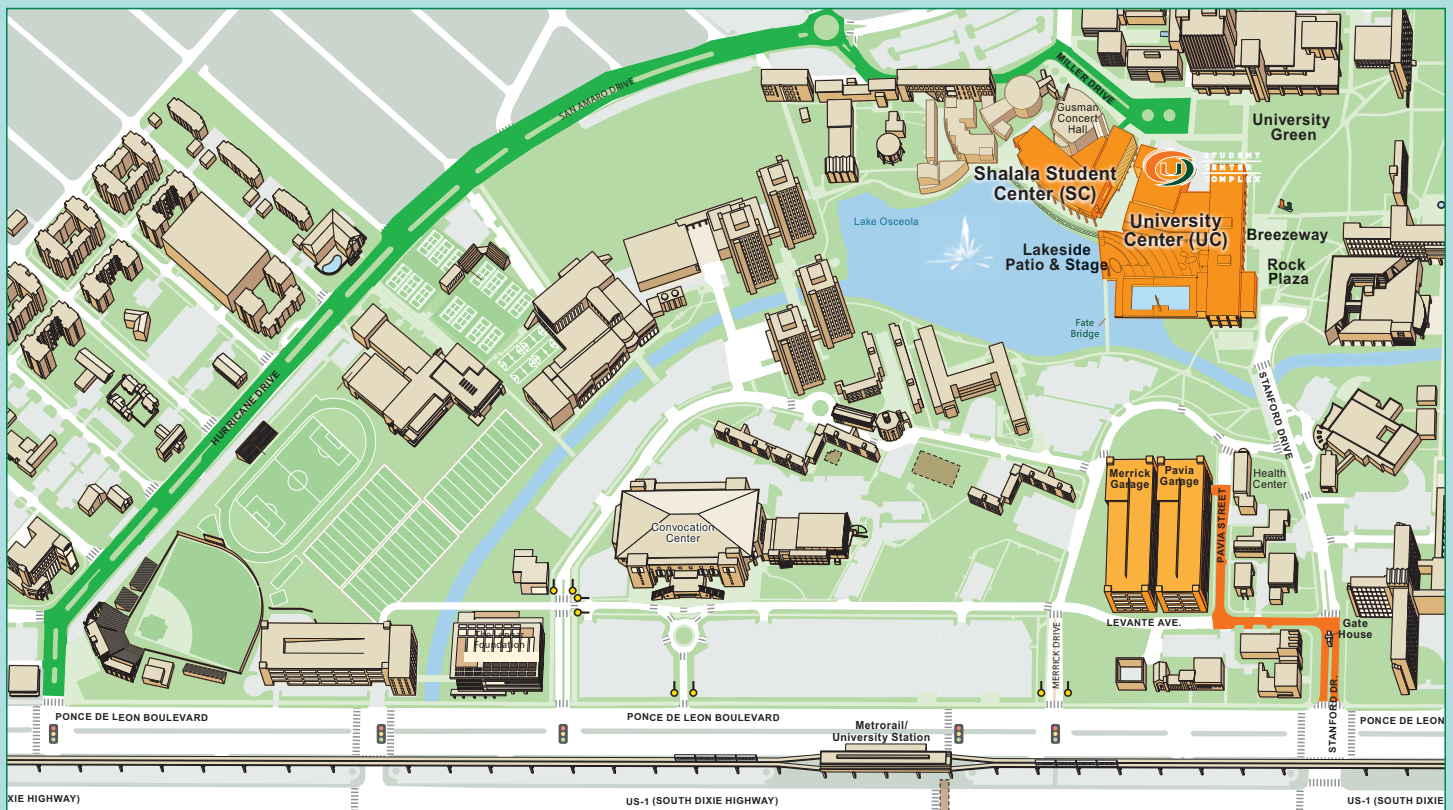



**STUDENT
CENTER
COMPLEX**

University of Miami
1330 Miller Drive
Coral Gables, Florida 33146

Reservations

305-284-4351

SCCReservations@miami.edu

www.miami.edu/SCCreservations

Information

305-284-4599

SCC@miami.edu

www.miami.edu/scc

U Miami SCC

**DONNA E. SHALALA
STUDENT
CENTER**

1330 MILLER



STUDENT
CENTER
COMPLEX



MEETINGS EVENTS CELEBRATIONS